



## ILLUMINATED PUSHBUTTON SWITCH

**KBL16 Series****CLASSIFICATION****KBL-16 S M - L 1C R 1**

① ② ③ ④ ⑤ ⑥

① SHAPE	NONE	ROUND	NONE	Ø18mm Head
			0	Ø25mm Head FlushType
			1	Ø25mm Head
② ACTUATOR	S	SQUARE		
	R	RECTANGULAR		
	M	MOMENTARY		
③ LAMP	AT	MAINTAINED		
	NONE	FILAMENT LAMP		
	L	LED LAMP		
④ INPUT VOLTAGE	1C	6V		
	2C	12V		
	3C	24V		
⑤ COLOR	R	RED		
	G	GREEN		
	Y	YELLOW		
	O	ORANGE		
	W	WHITE		
	B	BLUE		
⑥ CONTACTS	1	1C		
	2	2C		



CONTROL COMPONENTS

SQUARE LIGHT

TOWER LIGHT

MICRO SWITCH

FOOT SWITCH

LIMIT SWITCH

POWER SWITCH

HOIST SWITCH

CAM SWITCH

BUZZER

PHOTO SENSOR

PROXIMITY SENSOR

FLOATLESS LEVEL SWITCH

TIMER & COUNTER

RELAY

SOCKETS

TERMINAL BLOCK

CONTROL BOX

PID TEMP. CONTROLLER

**KBL16**



KBL16M  
KBL16AT

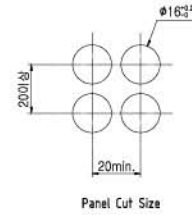
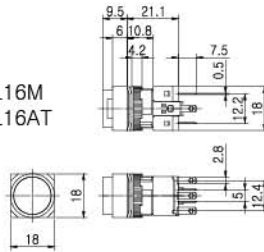

**KBL16S**



KBL16SM  
KBL16SAT

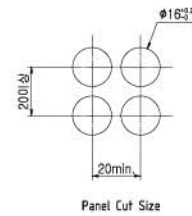
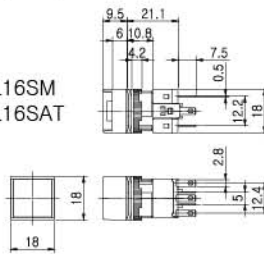

**KBL16R**



KBL16RM  
KBL16RAT

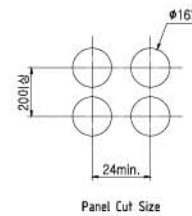
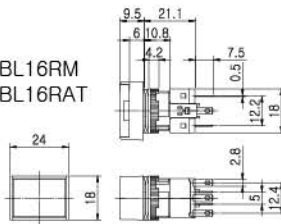

**KBL160**



KBL160M  
KBL160AT

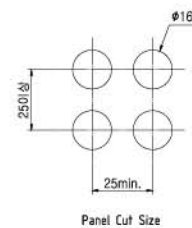
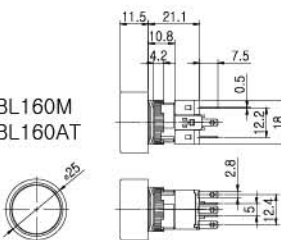

**KBL161**



KBL161M  
KBL161AT

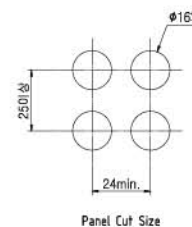
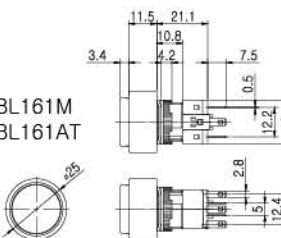



## Technical Information

### Switching System

The switching element of KPB16 is equipped with normally open contact and normally closed contact.

1C and 2C contact available.

### Material

#### Contact

Silver alloy + Copper

#### Housing

BODY: Nylon glass

CONTACT HOUSING: PBT

#### Buttons

PC

### Mechanical Characteristics

#### Mechanical Lifetime

Momentary type: 1,000,000 Cycles of operation

Maintained type: 200,000 Cycles of operation

#### Install

Tightening torque : Max. 6Kg/F.Cm

### Electrical Characteristics

#### Standards

This product comply with “ Standards for low-voltage switching devices” EN IEC 60947-5-1

#### Contact Ratings

250VAC 3A (resistive load)

#### Insulation Resistance

Minimum 100M $\Omega$  (500VDC)

#### Contact Resistance

Maximum 30m $\Omega$

#### Electrical Lifetime

100,000 cycles of operation



## Electrical Characteristics—continues

### Dielectric Strength

Between Live Parts: 1,000VAC(50/60Hz) for 1 minute

Between Live and Dead Parts: 1,000VAC(50/60Hz) for 1 minute

## Environmental conditions

### Operational Temperature

-15° C~+55° C

### Operational Humidity

45~85%RH

### Protection Degree

IP40

### Shock Resistance

Approximately 10G(1,000m/s<sup>2</sup>)

### Vibration Resistance

10~55Hz double amplitude 1.5mm (at X, Y and Z axis)

## Approvals

### Approbations

UL, CCC, KC

### Declaration of Conformity

CE

CONTROL  
COMPONENTS

SQUARE  
LIGHT

TOWER  
LIGHT

MICRO  
SWITCH

FOOT  
SWITCH

LIMIT  
SWITCH

POWER  
SWITCH

HOIST  
SWITCH

CAM  
SWITCH

BUZZER

PHOTO  
SENSOR

PROXIMITY  
SENSOR

FLOATLESS  
LEVEL SWITCH

TIMER &  
COUNTER

RELAY

SOCKETS

TERMINAL  
BLOCK

CONTROL  
BOX

PID TEMP.  
CONTROLLER