

Cable Glands - PG Series

케이블그랜드 / 电缆防护接头 - PG 系列

BC-PG CABLE GLAND

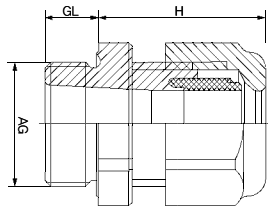

Model No.			Thread (AG)	Cable Ø (mm)	H (mm)	GL (mm)	Wrench (mm)
Grey	Dark Grey	Black					
BC-PG7-G	BC-PG7-D	BC-PG7-B	PG7	3~6.5	21	8	15
BC-PG9-G	BC-PG9-D	BC-PG9-B	PG9	4~8	21	8	19
BC-PG11-G	BC-PG11-D	BC-PG11-B	PG11	5~10	25	8	21
BC-PG13.5-G	BC-PG13.5-D	BC-PG13.5-B	PG13.5	6~12	27	9	23
BC-PG16-G	BC-PG16-D	BC-PG16-B	PG16	10~14	28	10	26
BC-PG19-G	BC-PG19-D	BC-PG19-B	PG19	12~16	30	10	25
BC-PG21-G	BC-PG21-D	BC-PG21-B	PG21	13~18	31	10	31
BC-PG25-G	BC-PG25-D	BC-PG25-B	PG25	16~21	34	11	34
BC-PG29-G	BC-PG29-D	BC-PG29-B	PG29	18~25	39	11	41
BC-PG36-G	BC-PG36-D	BC-PG36-B	PG36	22~32	48	13	51
BC-PG42-G	BC-PG42-D	BC-PG42-B	PG42	32~38	49	13	60
BC-PG48-G	BC-PG48-D	BC-PG48-B	PG48	37~44	49	14	64
BC-PG63-G	BC-PG63-D	BC-PG63-B	PG63	42~50	60	27	76

• Feature / 특성 / 特征

1. Material / 재질 / 材质 : PA (NYLON)
2. Hermetic seal / 밀봉 실 / 密封圈 : NBR
3. Washer / 와셔 / 平垫 : NBR
4. Color / 색상 / 颜色 : Grey, Black, Dark grey

BC-PG-L LONG CABLE GLAND

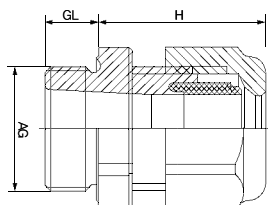

Model No.	Thread (AG)	Cable Ø (mm)	H (mm)	GL (mm)	Wrench (mm)
BC-PG7L-G	PG7	3~6.5	21	15	15
BC-PG9L-G	PG9	4~8	21	15	18
BC-PG11L-G	PG11	5~10	25	15	21
BC-PG13.5L-G	PG13.5	6~12	27	15	24
BC-PG16L-G	PG16	10~14	28	15	26
BC-PG21L-G	PG21	13~18	31	15	32
BC-PG29L-G	PG29	18~25	39	18	40
NEW BC-PG36L-G	PG36	22~32	48	18	50
NEW BC-PG42L-G	PG42	32~38	49	18	60
NEW BC-PG48L-G	PG48	37~44	49	18	65

• Feature / 특성 / 特征

1. Material / 재질 / 材质 : PA (NYLON)
2. Hermetic seal / 밀봉 실 / 密封圈 : NBR
3. Washer / 와셔 / 平垫 : NBR
4. Color / 색상 / 颜色 : Grey

- Dimensions and specifications are subject to change without notice.
- 규격 및 사양은 사전 예고 없이 변경될 수 있습니다.
- 厂家会在没有任何提前通知的情况下更改产品规格与样式。

▶ **BC-BP-PG BEND PROOF CABLE GLAND**



Model No.	Thread (AG)	Cable Ø (mm)	H (mm)	GL (mm)	Wrench (mm)
BC-BP-PG7	PG7	3-6.5	66	8	15
BC-BP-PG9	PG9	4-8	75	8	19
BC-BP-PG11	PG11	5-10	82	8	22
BC-BP-PG13.5	PG13.5	6-12	87	9	24
BC-BP-PG16	PG16	10-14	96	10	27
BC-BP-PG21	PG21	13-18	105	11	33

• Feature / 특성 / 特征

1. Material / 재질 / 材质 : PA (NYLON)
2. Hermetic seal / 밀봉 실 / 密封圈 : NBR
3. Washer / 와셔 / 平垫 : NBR
4. Color / 색상 / 颜色 : Grey

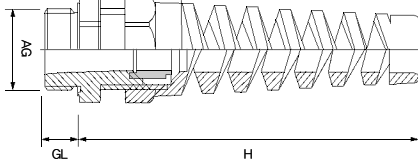

▶ **BC-MPG METAL CABLE GLAND**



Model No.	Thread (AG)	Cable Ø (mm)	H (mm)	GL (mm)	Wrench (mm)
BC-MPG7	PG7	4-7	22	6	14
BC-MPG9	PG9	5-8	27	7	18
BC-MPG11	PG11	6-10	28	8	20
BC-MPG13.5	PG13.5	8-12	30	9	22
BC-MPG16	PG16	10-14	30	9	24
BC-MPG19	PG19	10-14	33	9	24
BC-MPG21	PG21	13-18	34	9	30
BC-MPG25	PG25	15-22	38	9	34
BC-MPG29	PG29	18-25	42	9	40
BC-MPG36	PG36	25-32	45	10	50
BC-MPG42	PG42	32-38	50	14	58
BC-MPG48	PG48	37-44	50	12	64
BC-MPG63	PG63	43-52	55	15	78

• Feature / 특성 / 特征

1. Material / 재질 / 材质 : Nickel-plated brass
2. Hermetic seal / 밀봉 실 / 密封圈 : NBR
3. O-Ring / 오링 / O型圈 : NBR

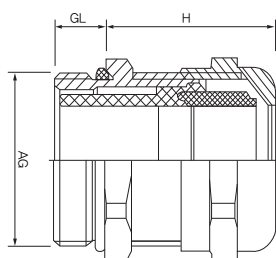

- Dimensions and specifications are subject to change without notice.
- 규격 및 사양은 사전 예고 없이 변경될 수 있습니다.
- 厂家会在没有任何提前通知的情况下更改产品规格与样式。

▶ BC-MPG-L METAL CABLE GLAND



Model No.	Thread (AG)	Cable Ø (mm)	H (mm)	GL (mm)	Wrench (mm)
BC-MPG7L	PG7	4~7	27	10	14
BC-MPG9L	PG9	5~8	33	10	18
BC-MPG11L	PG11	6~10	34	10	20
BC-MPG13.5L	PG13.5	8~12	35	10	22
BC-MPG16L	PG16	11~14	35	10	24
BC-MPG19L	PG19	10~12	37	10	30
BC-MPG21L	PG21	14~18	40	12	30
BC-MPG25L	PG25	16~21	42	12	36
BC-MPG29L	PG29	18~25	46	12	40
BC-MPG36L	PG36	25~32	48	15	50
BC-MPG42L	PG42	32~38	55	16	58
BC-MPG48L	PG48	38~44	55	16	64

• Feature / 특성 / 特征

1. Material / 재질 / 材质 : Nickel-plated brass
2. Hermetic seal / 밀봉 실 / 密封圈 : NBR
3. O-Ring / 오링 / O型圈 : NBR

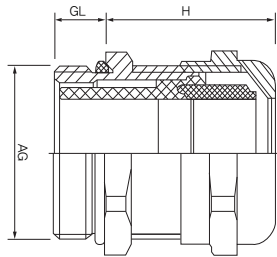

▶ BC-PKM-P PKM METAL CABLE GLAND



Model No.	Thread (AG)	Cable Ø (mm)	H (mm)	GL (mm)	Wrench (mm)
BC-PKM-P7	PG7	6~8	15	6	15
BC-PKM-P9	PG9	8~10	17	7	17
BC-PKM-P11	PG11	10~12	18	7	20
BC-PKM-P13.5	PG13.5	12~14	19.5	7	24

• Feature / 특성 / 特征

1. Material / 재질 / 材质 : Nickel-plated brass

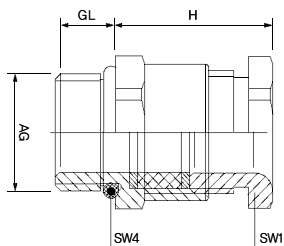

- Dimensions and specifications are subject to change without notice.
- 규격 및 사양은 사전 예고 없이 변경될 수 있습니다.
- 厂家会在没有任何提前通知的情况下更改产品规格与样式。

▶ BC-HSK-EX-P EX PLASTIC CABLE GLAND



Model No.	Thread (AG)	Cable Ø (mm)	H (mm)	GL (mm)	Wrench (mm)
BC-HSK-EX-P7	PG7	3~6.5	20	8	15
BC-HSK-EX-P9	PG9	4~8	22	8	19
BC-HSK-EX-P11	PG11	5~10	25	8	22
BC-HSK-EX-P13.5	PG13.5	6~12	26.5	9	24
BC-HSK-EX-P16	PG16	8~14	28	10	27
BC-HSK-EX-P21	PG21	13~18	31.5	11	33
BC-HSK-EX-P29	PG29	18~25	39	11	42
BC-HSK-EX-P36	PG36	22~32	48.5	13	53
BC-HSK-EX-P42	PG42	30~38	47.3	15	60
BC-HSK-EX-P48	PG48	37~44	47	15	65

• Feature / 특성 / 特征

1. Material / 재질 / 材质: Polyamide
2. Color / 색상 / 颜色: Grey

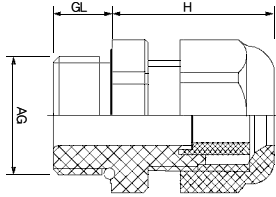

▶ BC-HSM-EX-P EX METAL CABLE GLAND



Model No.	Thread (AG)	Cable Ø (mm)	H (mm)	GL (mm)	Wrench (mm)
BC-HSM-EX-P7	PG7	3~6.5	19	6	14
BC-HSM-EX-P9	PG9	4~8	21	7	17
BC-HSM-EX-P11	PG11	5~10	23	7	20
BC-HSM-EX-P13.5	PG13.5	6~12	23.5	7	22
BC-HSM-EX-P16	PG16	8~14	23.5	7	24
BC-HSM-EX-P21	PG21	13~18	26	7	30
BC-HSM-EX-P29	PG29	18~25	33	8	40
BC-HSM-EX-P36	PG36	22~32	38	9	50
BC-HSM-EX-P42	PG42	30~38	40	9	58
BC-HSM-EX-P48	PG48	37~44	41.5	10	65

• Feature / 특성 / 特征

1. Material / 재질 / 材质: nickel-plated brass
2. Hermetic seal / 밀봉 실 / 密封圈: modified rubber

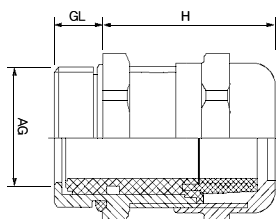

- Dimensions and specifications are subject to change without notice.
- 규격 및 사양은 사전 예고 없이 변경될 수 있습니다.
- 厂家会在没有任何提前通知的情况下更改产品规格与样式。

▶ BC-RG-PG RUBBER GROMMET PG



Article no.	Thread AD (mm)	Cable range (mm)	A (mm)	B (mm)	D (mm)	H (mm)	H1 (mm)
BC-RG-PG7	PG7	3-5	13	0.5-2	20	12.6	5.4
BC-RG-PG9	PG9	5-7	16	1-4	21	17.8	10.3
BC-RG-PG11	PG11	7-10	19	1-4	24	19.8	12.7
BC-RG-PG16	PG16	10-14	23	1-4	28	21.6	14.7
BC-RG-PG21	PG21	14-20	29	1-4	35	24.6	17.6
BC-RG-PG29	PG29	20-26	38	1-4	46	28.5	20
BC-RG-PG36	PG36	26-35	48	1-4	58	34.9	23.9

• Feature / 특성 / 特征

1. Material / 재질 / 材质 : EPDM
2. Color / 색상 / 颜色 : Grey

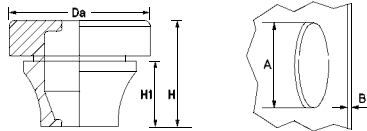

▶ BC-SP-PG HOLE PLUG



Model No.	A (mm)	B (mm)	B (mm)	C (mm)
BC-SP-PG7	PG7	12.2	9	16
BC-SP-PG9	PG9	12.2	9	19
BC-SP-PG11	PG11	12	9	22
BC-SP-PG13.5	PG13.5	14.6	11	25
BC-SP-PG16	PG16	14.5	11.2	27
BC-SP-PG21	PG21	14.6	11.2	33
BC-SP-PG29	PG29	15.8	12	44
BC-SP-PG36	PG36	16.5	12.5	55
BC-SP-PG42	PG42	16.5	12.5	62
BC-SP-PG48	PG48	16.4	12.0	69

• Feature / 특성 / 特征

1. Material / 재질 / 材质 : PA (NYLON)
2. Color / 색상 / 颜色 : Grey

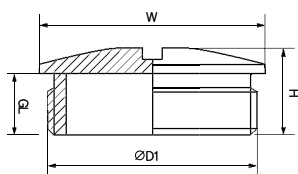

- Dimensions and specifications are subject to change without notice.
- 규격 및 사양은 사전 예고 없이 변경될 수 있습니다.
- 厂家会在没有任何提前通知的情况下更改产品规格与样式。

▶ **BC-MSP-PG METAL SCREW PLUG**



Model No.	D1 (mm)	H (mm)	GL (mm)	Wrench (mm)
BC-MSP-PG7	PG7	9.7	7	14
BC-MSP-PG9	PG9	9.7	7	18
BC-MSP-PG11	PG11	10	7	20
BC-MSP-PG13.5	PG13.5	11.5	8	22
BC-MSP-PG16	PG16	10.5	7	24
BC-MSP-PG19	PG19	10.5	7	26
BC-MSP-PG21	PG21	11	7.8	30
BC-MSP-PG25	PG25	11	8	32
BC-MSP-PG29	PG29	13	9.5	40
BC-MSP-PG36	PG36	14	9.5	50
BC-MSP-PG42	PG42	15	9.5	57
BC-MSP-PG48	PG48	15	10	64

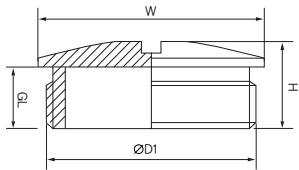

• Feature / 특성 / 特征

1. Material / 재질 / 材质 : Nickel-plated brass

▶ **BC-HP HOLE PLUG**



Model No.	A	D	L	L1
BC-HP-8	7.8	11.9	1.6	8
BC-HP-10	9.5	13	1.6	10.5
BC-HP-13	12.7	16.9	1.6	10.5
BC-HP-16	15.9	19.8	1.6	10.5
BC-HP-19	19	22.9	1.6	10.5
BC-HP-22	22.2	24.9	1.6	11.5
BC-HP-26	25.5	28.3	1.6	11.5
BC-HP-30	30	34.2	1.6	11.5

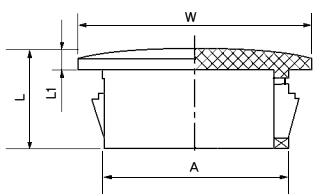

• Feature / 특성 / 特征

1. Material / 재질 / 材质 : PA
2. Color / 색상 / 颜色 : Black

- Dimensions and specifications are subject to change without notice.
- 규격 및 사양은 사전 예고 없이 변경될 수 있습니다.
- 厂家会在没有任何提前通知的情况下更改产品规格与样式。

BC-DPM-P HEXAGON PLUG



Model No.	D1 (mm)	H (mm)	GL (mm)	Wrench (mm)
BC-DPM-P7	PG7	8	5	14
BC-DPM-P9	PG9	9	6	17
BC-DPM-P11	PG11	9	6	20
BC-DPM-P13.5	PG13.5	9.5	6.5	22
BC-DPM-P16	PG16	9.5	6.5	24
BC-DPM-P21	PG21	11	7	30
BC-DPM-P29	PG29	12	8	39
BC-DPM-P36	PG36	15	9	50
BC-DPM-P42	PG42	16	10	57
BC-DPM-P48	PG48	16	10	64

• Feature / 특성 / 特征

1. Material / 재질 / 材质 : Nickel-plated brass

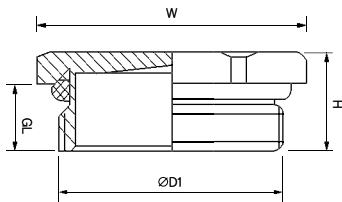

NEW BC-MRH-PG Metal Reducer



Model No.	D1 (mm)	D2 (mm)	GL (mm)	H (mm)
BC-MRH-PG0907	PG9	PG7	6	9
BC-MRH-PG1107	PG11	PG7	6	9
BC-MRH-PG1109	PG11	PG9	6	9
BC-MRH-PG1309	PG13.5	PG9	6.5	9.5
BC-MRH-PG1609	PG16	PG9	6.5	9.5
BC-MRH-PG1611	PG16	PG11	6.5	9.5
BC-MRH-PG1613	PG16	PG13.5	6.5	9.5
BC-MRH-PG2111	PG21	PG11	7	10.3
BC-MRH-PG2113	PG21	PG13.5	7	10.3
BC-MRH-PG2116	PG21	PG16	7	10.3
BC-MRH-PG2916	PG29	PG16	8	11.5
BC-MRH-PG2921	PG29	PG21	8	11.5
BC-MRH-PG3621	PG36	PG21	9	12.5
BC-MRH-PG3629	PG36	PG29	9	12.5
BC-MRH-PG4229	PG42	PG29	10	13.5
BC-MRH-PG4236	PG42	PG36	10	13.5
BC-MRH-PG4836	PG48	PG36	10	14
BC-MRH-PG4832	PG48	PG42	10	14

• Feature / 특성 / 特征

1. Material / 재질 / 材质 : Nickel-plated brass / 니켈도금황동 / 外部金属为黄铜镀镍

• Dimensions and specifications are subject to change without notice.

• 규격 및 사양은 사전 예고 없이 변경될 수 있습니다.

• 厂家会在没有任何提前通知的情况下更改产品规格与样式。

